

Nuts

Square Nuts

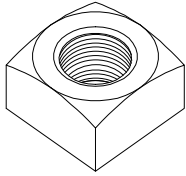

Hex Nuts

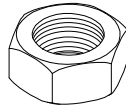

Catalog Number	Bolt Diameter	Approx. Wt. Lbs. Per C.
N3	3/8"	3
N4	1/2"	6
N5	5/8"	10
N6	3/4"	14
N7	7/8"	24
N8	1"	37

To order Hex Nuts, add suffix "-H" to the above numbers.

MF Locknuts

Square MF Locknuts

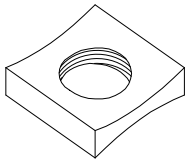

Hex MF Locknuts

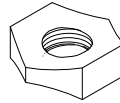

Catalog Number	Bolt Diameter	Approx. Wt. Lbs. Per C.
MF3	3/8"	1
MF4	1/2"	2
MF5	5/8"	4
MF6	3/4"	6
MF7	7/8"	8
MF8	1"	12

To order Hex Nuts, add suffix "-H" to the above numbers.

Eye Nuts

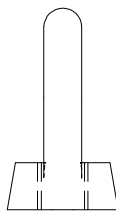
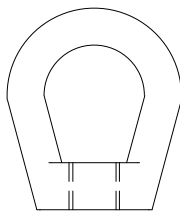

Catalog Number	Bolt Diameter	Approx. Wt. Lbs. Per C.
EN5	5/8"	60
EN6	3/4"	60
EN7	7/8"	150

Welded Washer Nuts

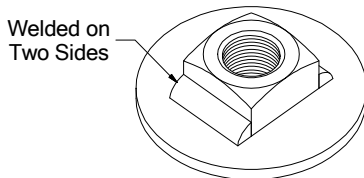

Catalog Number	Bolt Diameter	Outside Diameter "OD"	Washer Thickness "T"	Approx. Wt. Lbs. Per C.
WN4	1/2"	2"	9/64"	26
WN5	5/8"	2 1/2"	1/4"	42
WN6	3/4"	3"	1/4"	61
WN7	7/8"	3"	5/16"	105
WN8	1"	3 3/4"	3/8"	165